



# Timber Castle

AND CUSTOMS INC.

*A Choice in Lifestyle*



## The Glacier Bay

As inspiring as its name implies, the Glacier Bay provides such amenities as octagonal stairs, a bridge spanning the second floor, and artful oversized windows to capture natural light. Stair from both the living room and the garage lead to a massive lower-level family room, affording the informal space to relax and unwind.

**Rooms:**

3 Bedrooms

2 Baths

2 Half-Baths

**Square Footage:**

1,658 First Floor

1,030 Second Floor

1,577 Walkout

**4,265 Total**

# Floor Plans



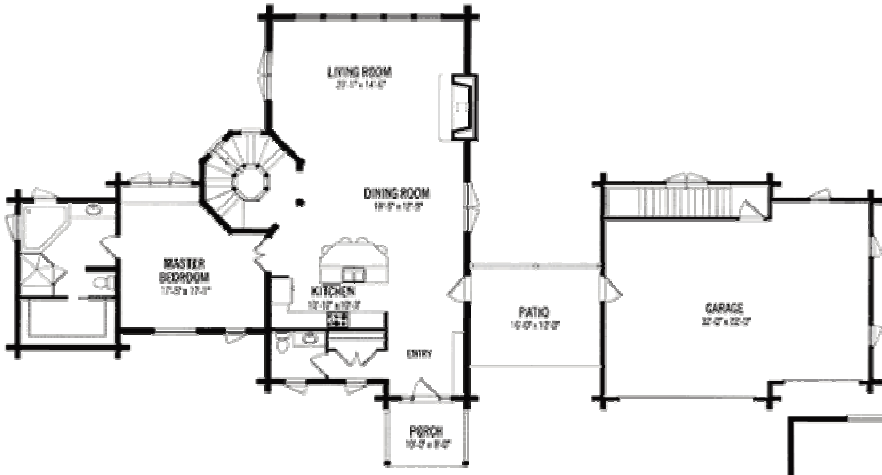

FIRST FLOOR

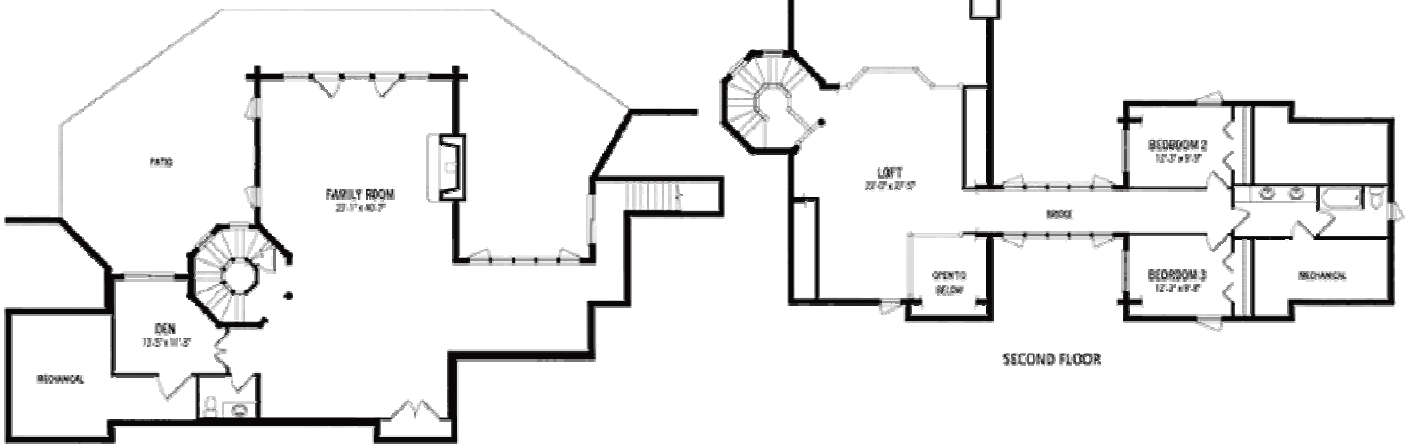

LOWER LEVEL

SECOND FLOOR

# Package Information

## Log Package 1

### Log Wall System

- Exterior Log
- Walls Screws
- Gasket
- Energy Seal
- Dowels
- Chinking (for chinked log styles)

### Log Siding

- Floor System Band
- Exterior Gables
- Exterior Dormers
- Exterior Walkout Lower Level
- Exterior Garage
- Exterior Knee Walls Under Porch
- Interior Cathedral Gables

### Posts & Beams

- Heavy Timber Support Posts & Beams
- Second Floor Joists
- Beam Hangers

### Porch System

- Porch Posts
- Porch Beams
- Porch Rafters

### Tongue & Groove

- 2x6 T&G Porch Roof Sheathing
- 2x6 T&G Second Floor Subfloor
- 1x6 T&G Flat Ceilings
- 1x6 T&G Cathedral Ceilings

### Log Home Finish

- Sikkens Log & Siding Exterior Finish
- Perma-Chink Lifeline Interior Finish
- Perma-Chink Acrylic Interior

## Log Package 2

### First Floor System

- Pressure Treated Sill & Sill Seal
- Girder(s)
- I-Joist Floor System
- 3/4" High Performance T&G Subfloor
- Hangers & Clips

### Rough Framing

- Interior Wall Framing
- Exterior Wall Framing
- 7/16" OSB Exterior Wall Sheathing
- Housewrap
- Laminated Stair Stringers
- Pine Risers
- Southern Yellow Pine Treads

### Roof System

- Ridge Beam/Board
- Rafters
- OSB Roof Decking

### Overhangs

- 2x4 & 2x6 Framing for Rakes and Lookouts
- 2x6 Subfascia
- 1x6 T&G Soffit
- 2" Strip Vent

### Porch & Deck Framing

- Pressure Treated Deck Framing
- Pressure Treated 5/4" Decking

### Exterior Finish Materials

- 1x4 RS Cedar Trim for Windows & Doors
- 1x8 RS Cedar Fascia

### Windows & Doors

- Pella ProLine Windows & Patio Doors
- Timber Valley Millwork Pine Valley Collection Front Door
- Pella Fiberglass Secondary Entry Doors
- Steel Fire Doors

---

## Contact Information:

### David Nedohin:

d.nedohin@timbercastleandcustoms.com

Phone: 780-616-6853

Fax: 780-486-3413

9932 81 Ave, Edmonton, AB  
T6E 1W6